

## Gebrauchsanleitung

Komfort-Schiebe-Befestigung  
mit Druckschloß

## Instructions for use

Comfort sliding fitting  
with push button lock

## Instructions d'utilisation

Montage glissé facile  
avec la serrure de pression

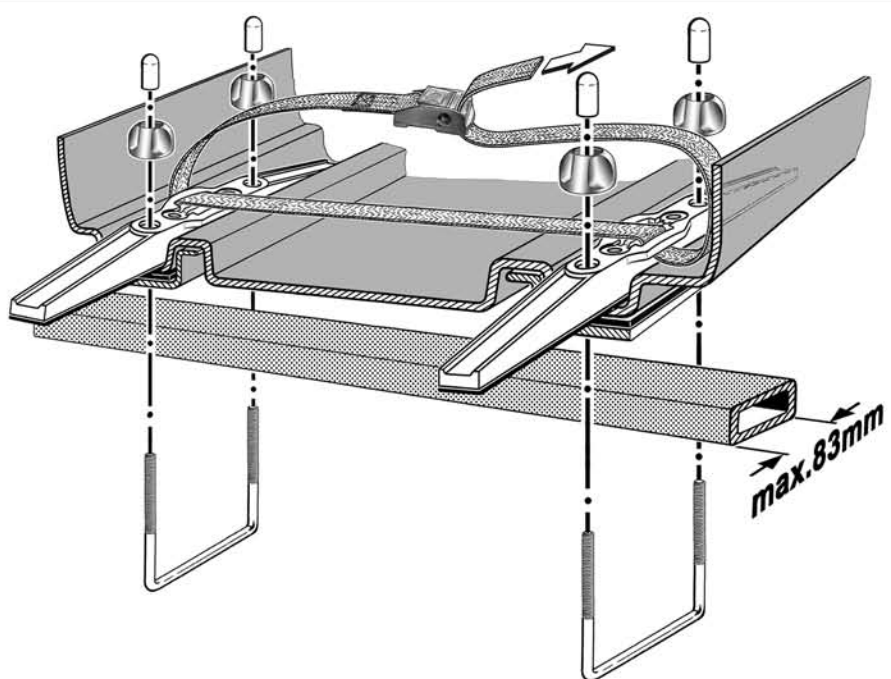
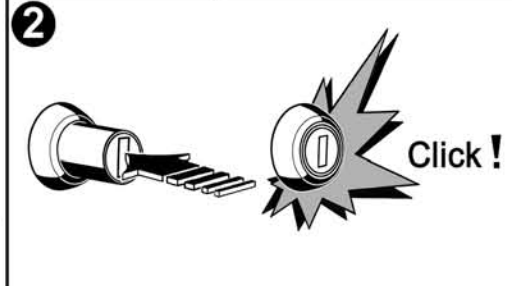
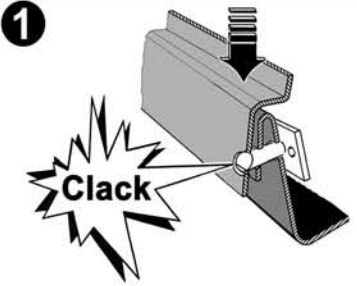
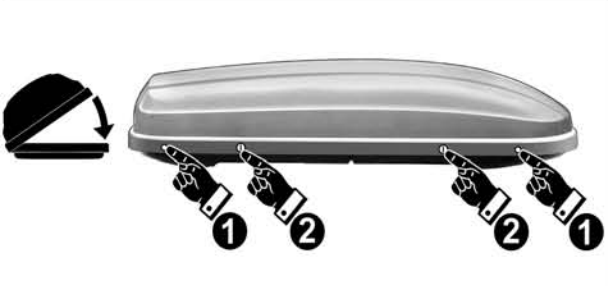
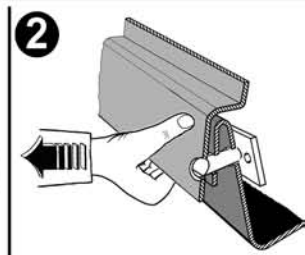
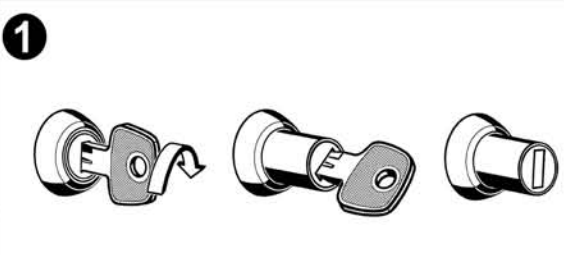
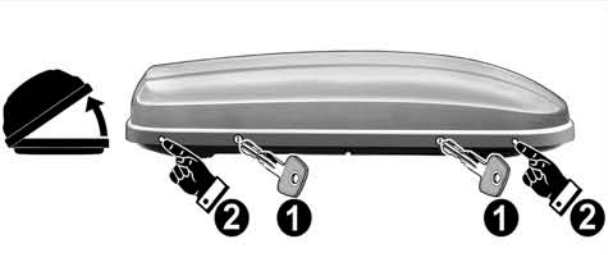
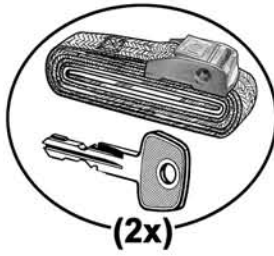
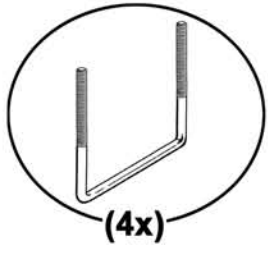

Art.-Nr. 0 52003 10

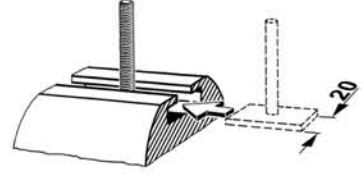

Art.-Nr. 0 52004 10

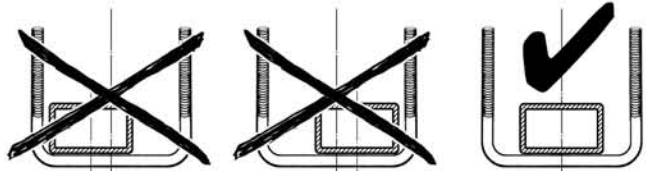
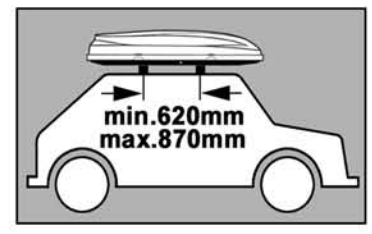
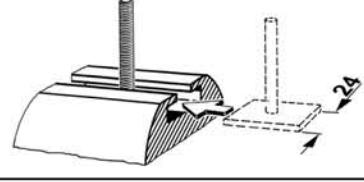

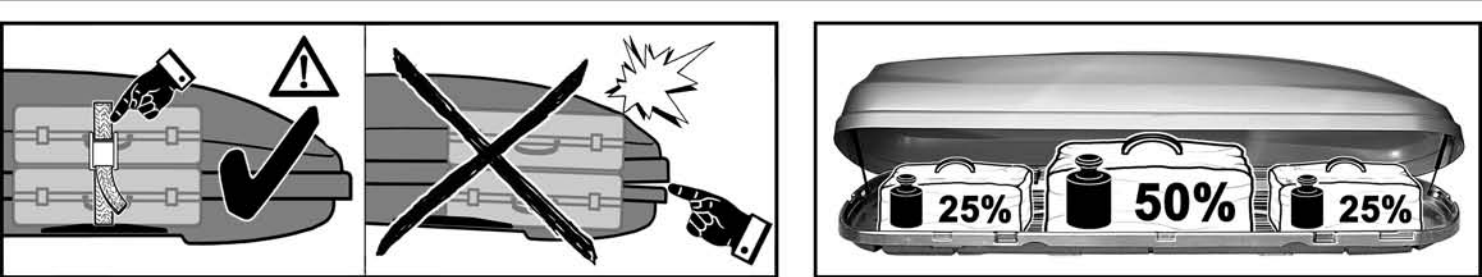
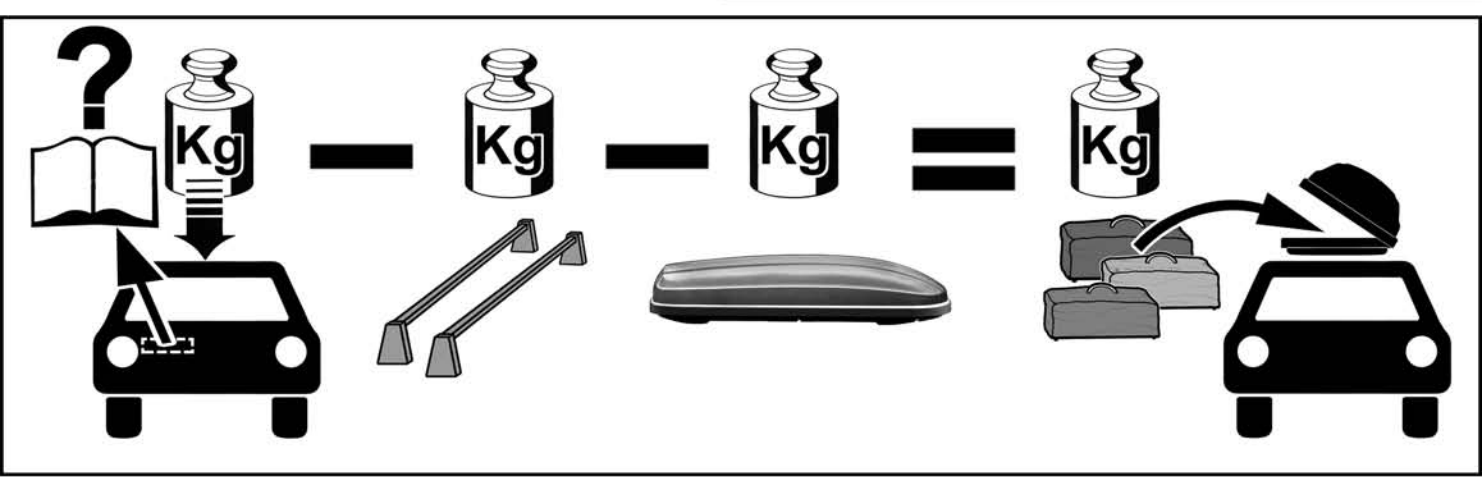
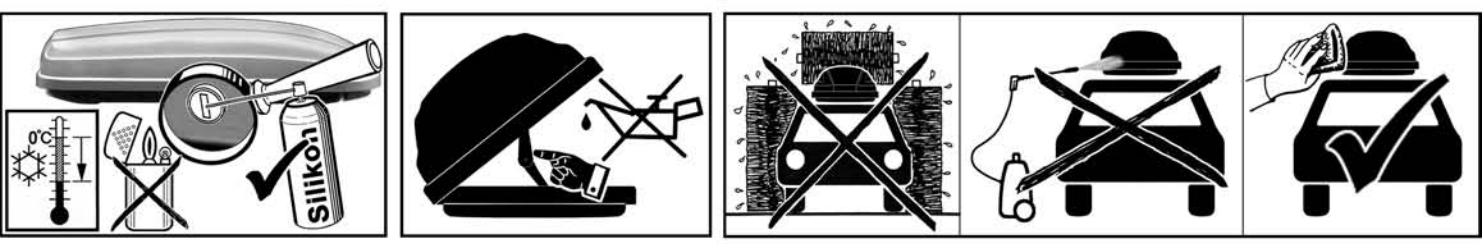
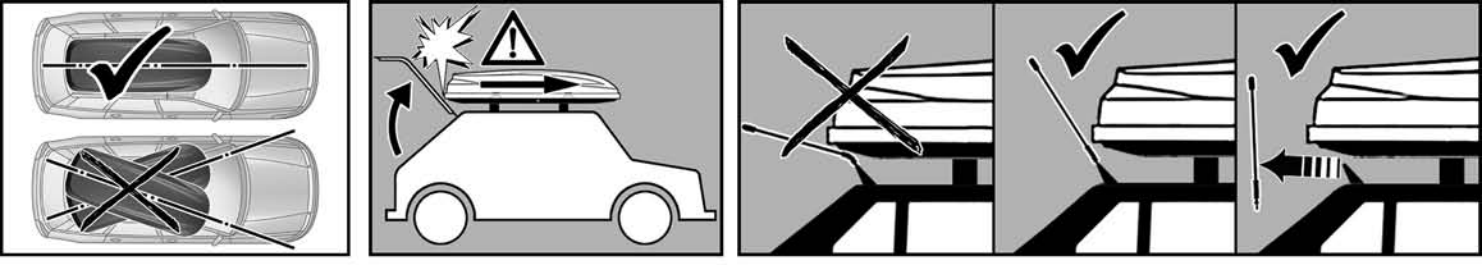

Dachcontainer Typ 81200

Hersteller: KAMEI 01805 - 26 34 46

Haupt-Verkaufsbezeichnung	Maße			Volumen Schüttgut Liter	Eigengewicht kg	Gewichte	
	Länge cm	Breite cm	Höhe cm			zulässige Tragfähigkeit kg	Maximalgewicht beladen kg
Husky L	190	75	38	330	13	50	63
Kamei 450	220*	82	38	450	19	50	69
Kamei 300	220*	62	35	300	14	50	64

\* Für den Transport von Ski sind Skihalter-Einsätze gesondert lieferbar

\* Special ski holders are available for the transportation of skis.

\* Pour le transport de skis, des éléments porte-skis sont livrables séparément